

77 m Slup modern Sailingyacht A252

Konzept + Projekt

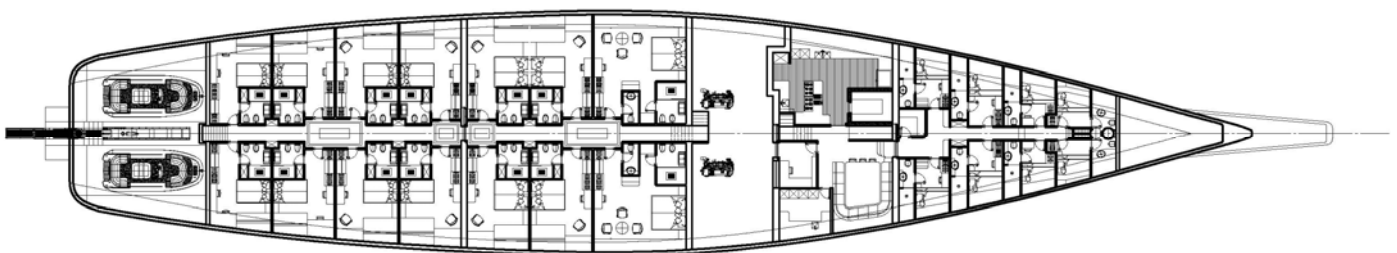
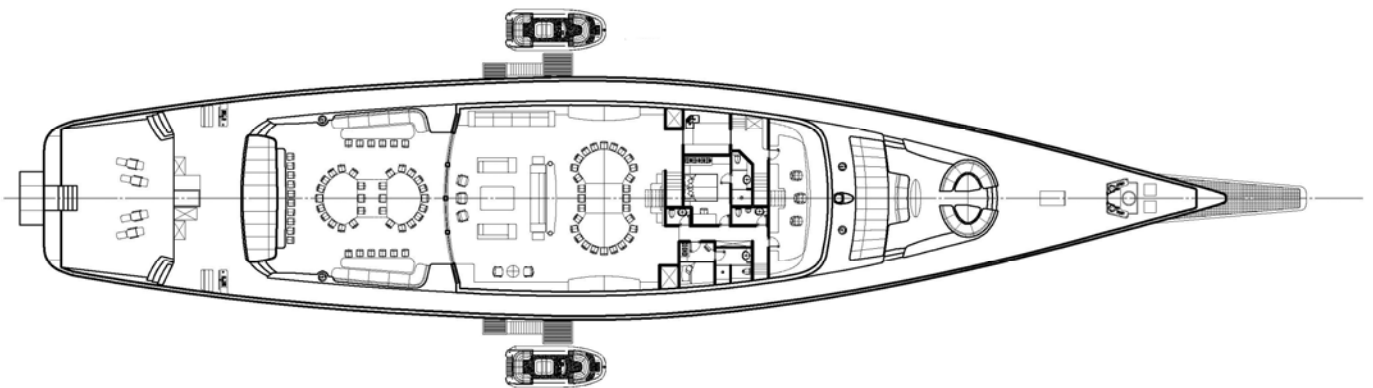
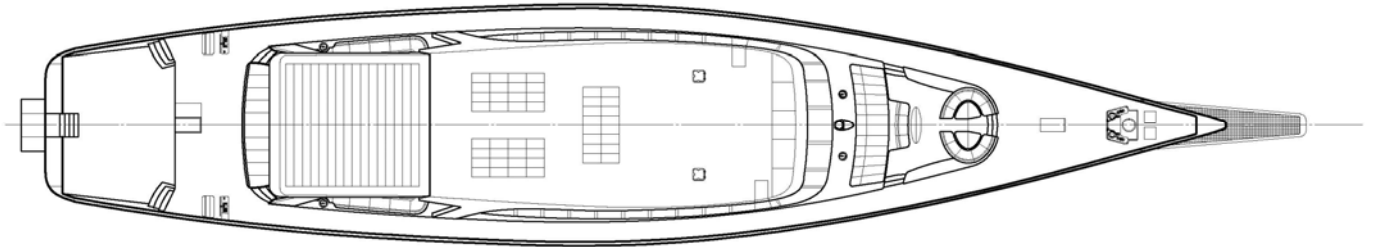
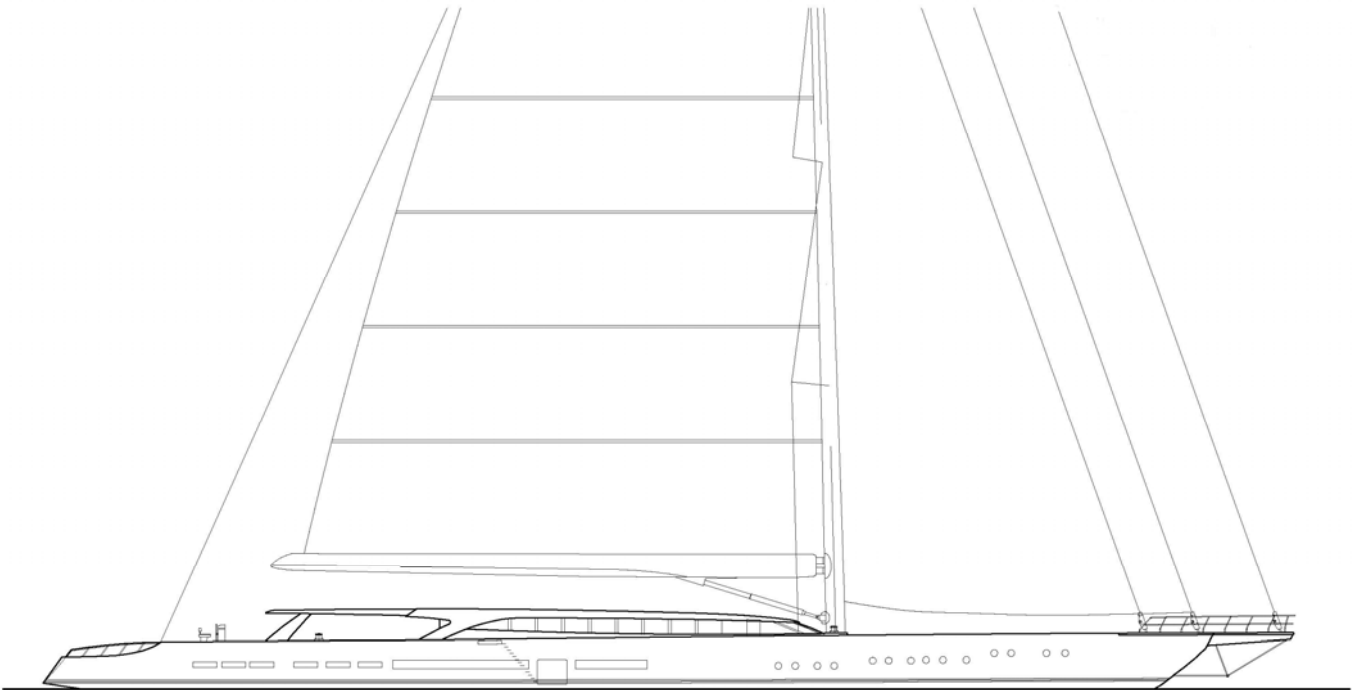

77 m Slup modern Sailingyacht A252

Konzept + Projekt

Sailing Yacht Sloop - Eastern Mediterranean / Caribbean

Designer	Joachim Kinder, Munich		Engines	2x 795 kW, MTU
Yard	has not yet been determined		Generator	2x 245 kW
Length over all (with Bow sprit)	78.50 m / 257'55"			1x 80 kW/Northern Lights
Length over deck	73.50 m / 241'14"		Watermakers	2x Seafresh T25, 25.000 l / per day
Length WL	67.23 m / 220'57"		Air-Conditioning	Heinen & Hopman, Fancoil
Beam	15.00 m / 49'21"		Fuel capacity	60'000 lt
Draft (keel up)	3.50 m / 11'48"		Bow thruster	1x 90hp, retractable
Draft (keel down)	7.50 m / 24'61"		Stern thruster	1x 90hp, retractable
Mast Carbon	83.29 m / 273'26"		Bow anchor	2x 150 m
Tender	2xCastoldi 'Jet-Tender 21'		Stern anchor	2x 120 m
	Passenger capability (C.E. Directive): No. 12		Cruising Speed	14 Knots
			Range	5.000 sm
Displacement	approx.	720 tons	Accommodation	28 Guest in 14 Cabins
Construction		Aluminium	Crew	16 Crew in 8 Cabins
Main sail	approx.	1306 sq.m	Classification	MCA, Germanischer Lloyd, LY2
Sail area (sum)	approx.	2401 sq.m	Flag	Malta

